

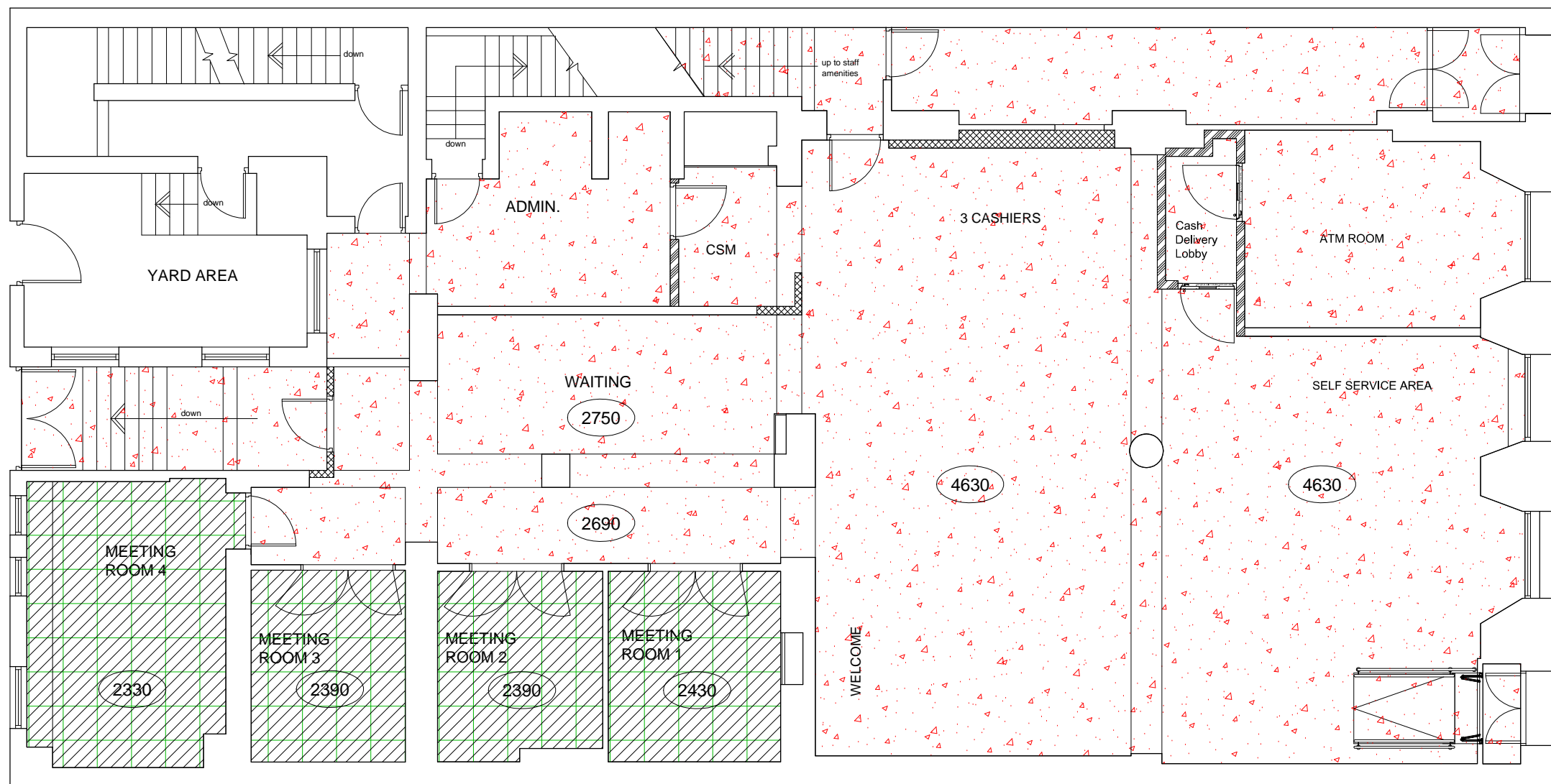

SCALE

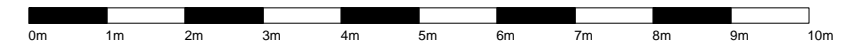
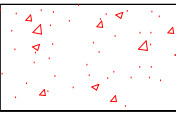
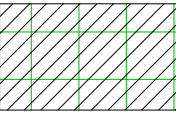
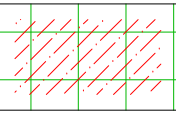
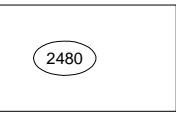

KEY

-  Redecorate plaster ceilings to MATCH
-  Replace damaged ceiling tiles to MATCH existing
-  Hatch indicates the extent of cut / modified existing ceiling grid and tiles to suit new partition construction
-  Floor to Ceiling height
-  Back of Office
No Works - EXISTING

GROUND FLOOR PLAN

REV	DATE	REVISION	INITIALS
<p>LLOYDS BANKING GROUP</p> <p>ALL DIMENSIONS TO BE VERIFIED PRIOR TO COMMENCING WORK. DRAWING TO BE READ IN CONJUNCTION WITH PROJECT SPECIFICATIONS.</p> <p>THIS DRAWING IS THE PROPERTY OF LLOYDS BANKING GROUP AND COPYRIGHT IS RESERVED BY THEM. THE DRAWING IS ISSUED ON CONDITION THAT IT IS NOT COPIED OR DISCLOSED BY OR TO ANY UNAUTHORISED PERSONS WITHOUT PRIOR CONSENT IN WRITING TO LLOYDS BANKING GROUP - GROUP PROPERTY. ALL MODIFIED DRAWINGS SHOULD BE RETURNED TO LLOYDS BANKING GROUP.</p> <p>GROUP PROPERTY</p> <p>BRISTOL - PO Box 112, Canons House, Canons Way, BRISTOL, BS99 7LB EDINBURGH - Signal South, 12 Bankhead Crossway South, EDINBURGH, EH11 4EN HALIFAX - Trinity Road, HALIFAX, West Yorkshire, HX1 2RG</p>			
PROJECT ADDRESS		SCALE	
Lloyds Bank South Shields, King Street 101 King Street SOUTH SHIELDS NE33 1DT		A1 - 1:50 A3 - 1:100	
DRAWING DESCRIPTION		DATE	
Ground Floor Proposed Ceiling Plan		27.01.15	
DRAWING NUMBER		DRAWN BY	
50689600-AR01-00-0801		GAR	
		REVISION	
		-	